

1. WHY SHORTER SHOWERS?

Long showers are one of the main drivers of water and energy consumption in homes. Hot water use is largely influenced by showering and accounts for approximately 40% of total household energy use.

A large portion of our water comes from desalination - an energy intense process, so reducing water use saves energy and reduces the need for desalination.

Shorter showers save water and energy, saving you money and reducing carbon emissions. 4 minutes is the recommended, environmentally sustainable shower duration.

2. WHAT'S IN THE BOX?

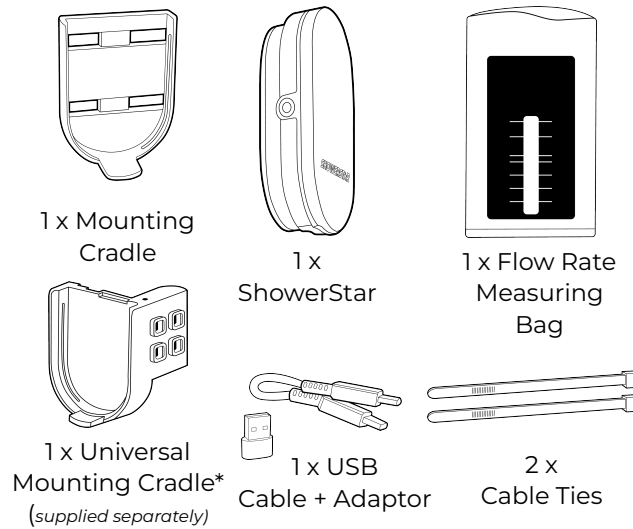

3. POWER ON + CHARGE

Press to Power On (3 Seconds)

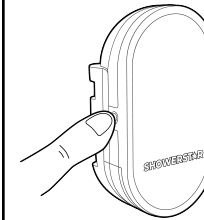

LEDS illuminate **RED, GREEN, BLUE**

Connect to USB Charger

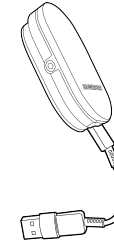

LEDS illuminate **RED** when charging and **GREEN** when fully charged

4. MOUNTING

ShowerStar senses vibrations from water flowing through piping or shower-heads. Correct mounting is **CRITICAL** to ensure water flow is sensed. Use the supplied cable ties and make sure the mounting bracket is **attached tightly** to the piping or shower-head to ensure vibrations can be transmitted to the ShowerStar. Trim cable ties for a neat installation.

See mounting options overleaf.

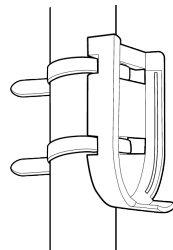

Scan QR code for product support, videos, FAQ and manuals.

5. INSERT SHOWERSTAR

Insert ShowerStar fully into mounting cradle so it is properly seated and the USB port is covered.

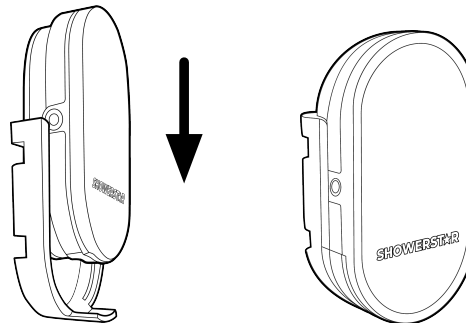

6. TEST

When ShowerStar detects water flowing it illuminates **BLUE**. After the warm up delay (30 seconds default) it illuminates **GREEN**, indicating the shower timer has started and sensing is working correctly.

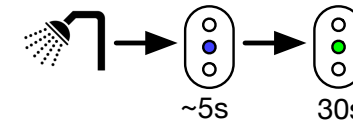

If it does not illuminate **BLUE** then **GREEN** check the mounting cradle is tightly attached. You may need to move the mounting cradle to another location if ShowerStar fails to sense correctly.

MOUNTING - RIGID PIPE

Use the standard OR universal mounting cradle and mount ShowerStar onto piping with supplied cable ties - ideally around chest height.

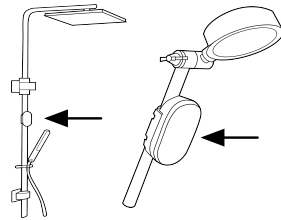

MOUNTING - FLEXIBLE PIPE

Use the standard mounting cradle and mount ShowerStar a short distance below the elbow connector (the opposite end to the hand held shower).

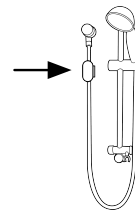

MOUNTING - SHOWERHEAD

Use the universal mounting cradle and fix the ShowerStar to the side of the shower-head.

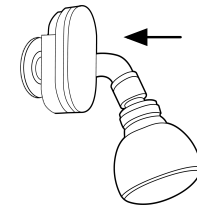

APP (OPTIONAL)

1. DOWNLOAD APP

Download 'ShowerStar' App from the App or Google Play Stores.



2. OPEN APP

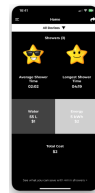

3. TURN ON BLUETOOTH

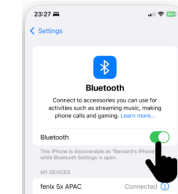

4. ADD DEVICE + PAIR



5. CONFIGURE APP + ALERTS

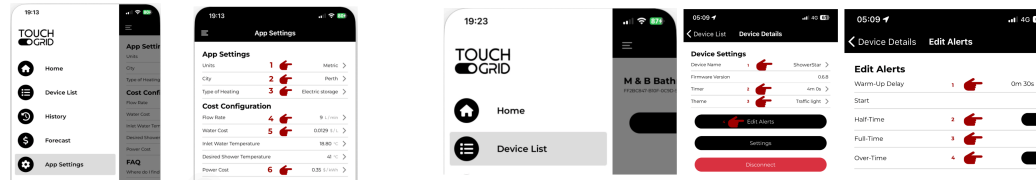

SUPPORT



Scan QR code for product support, videos, FAQ and manuals.

ALERTS

