

Quick Start Guide

Installing ShowerStar

1. Charge the ShowerStar

Press to Power On
(3 Seconds)

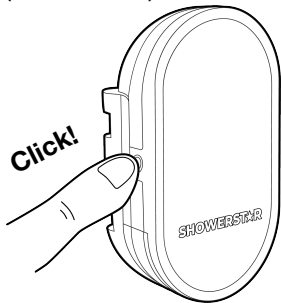

Connect to USB
Charger (not supplied)
for 4-6 hours.

LEDS illuminate
Red when
charging and **Green**
when fully charged.

Press for 3 seconds
to Power On. LEDES
illuminate **Red**,
Green, **Blue**.

Charge lasts ~6-8 months.

2. Select shower type and cradle

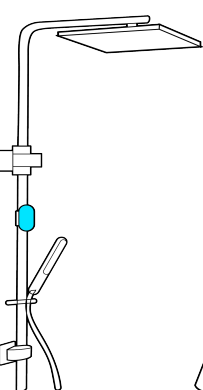

Rigid pipe

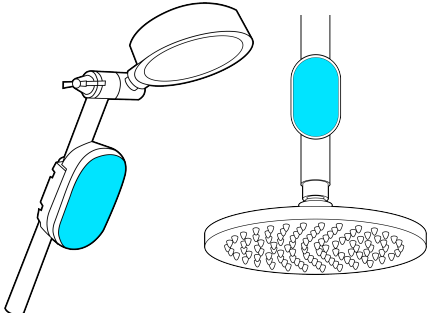

Flexible pipe

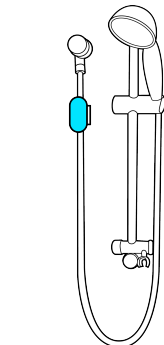

Showerheads

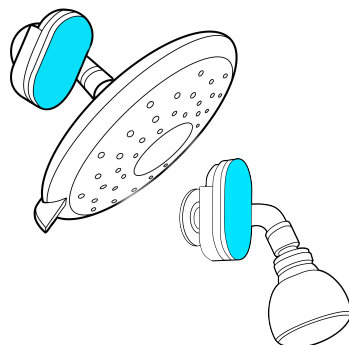

Use Universal or
Standard cradle



Use Standard
cradle



Use Universal
cradle

3. Zip tie the cradle to the shower pipe

ShowerStar senses vibrations
from water flowing through
shower piping.

It is **CRITICAL** that the cradle is
touching the shower pipe.

ZIP TIE THE CRADLE TIGHTLY
TO THE SHOWER PIPE.



Watch
video

1. Insert zip ties
(Universal cradle side
mount example)

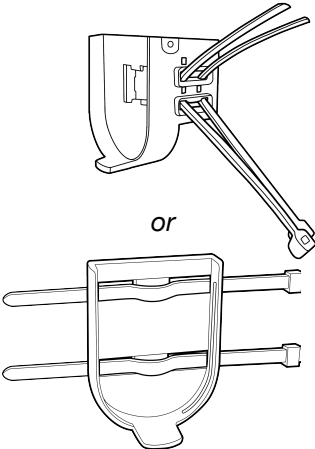

(Standard cradle example)

2. Zip tie cradle to pipe

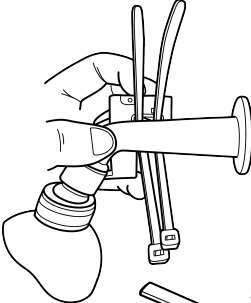

3. Trim zip ties

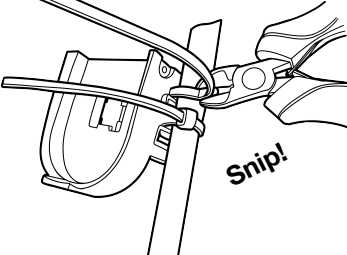

4. Insert ShowerStar fully

Insert ShowerStar into the cradle. It must be
inserted fully to protect the USB port from water.

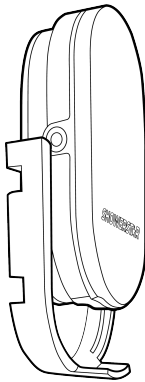

Slide!



Quick Start Guide

Configuring the App

1. Download the App
2. Open App
3. Pair the ShowerStar and phone
4. Update firmware

Download ‘ShowerStar’ App from the App or Google Play Store.

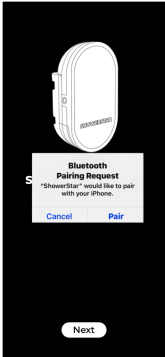
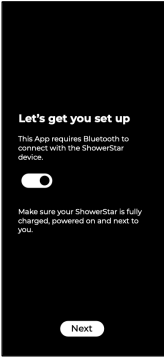
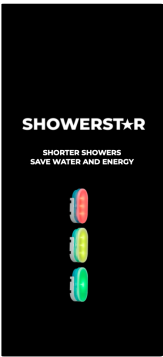

You *may* be prompted to update the firmware on your ShowerStar

5. Name
6. Customise settings

When showering, ShowerStar shows these alerts

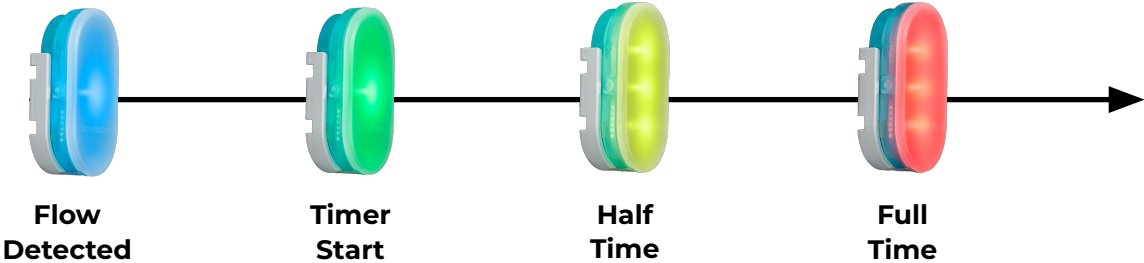
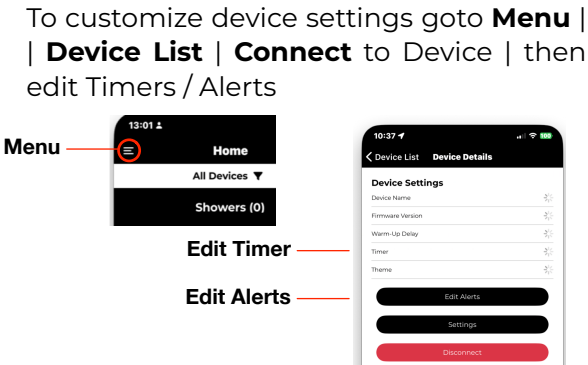

Videos



Watch the video instructions



App



Install the App to track your progress



Join



Sign up to our community for perks



Help



Get help from real humans

